

## Site Plot Plan

Owner \_\_\_\_\_

Street Address \_\_\_\_\_

Phone No. \_\_\_\_\_

Estimated Cost:

In the space provided, draw plot plan as neatly and accurately as possible, from survey if possible.

- 1 Show North Arrow.
- 2 Identification of the drawing's scale, if used.
- 3 Draw property lines with dimensions; front, side and rear setback dimensions; all easements with dimensions.
- 4 Draw street(s) and right-of-way(s).
- 5 Draw proposed and existing buildings showing any attached porch(es), deck(s), chimney(s), carport(s), garage(s), etc. with dimensions.
- 6 Show distances of buildings from property lines or other structures.
- 7 Identification of exactly what work is to be done, including any proposed changes to physical features of the site or existing structures.
- 8 Location and dimensions of any graveled or impervious paved areas such as driveways or parking.
- 9 Ground elevations and contour lines for sloping sites or where earth grading is proposed may be required. Check with the Director of Public Works to verify if this is required.

### Plot Plan Example

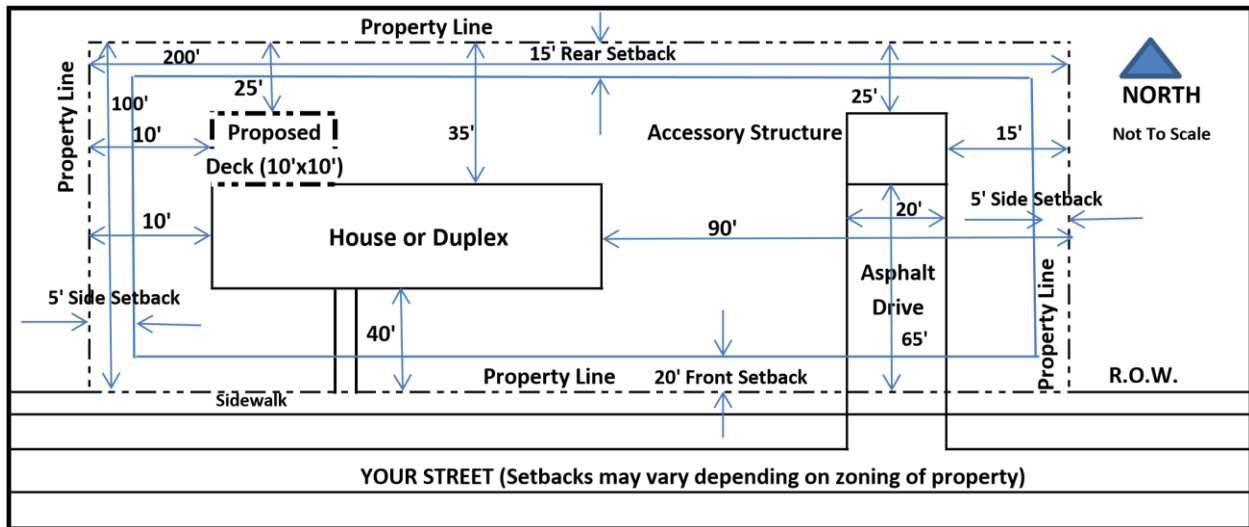

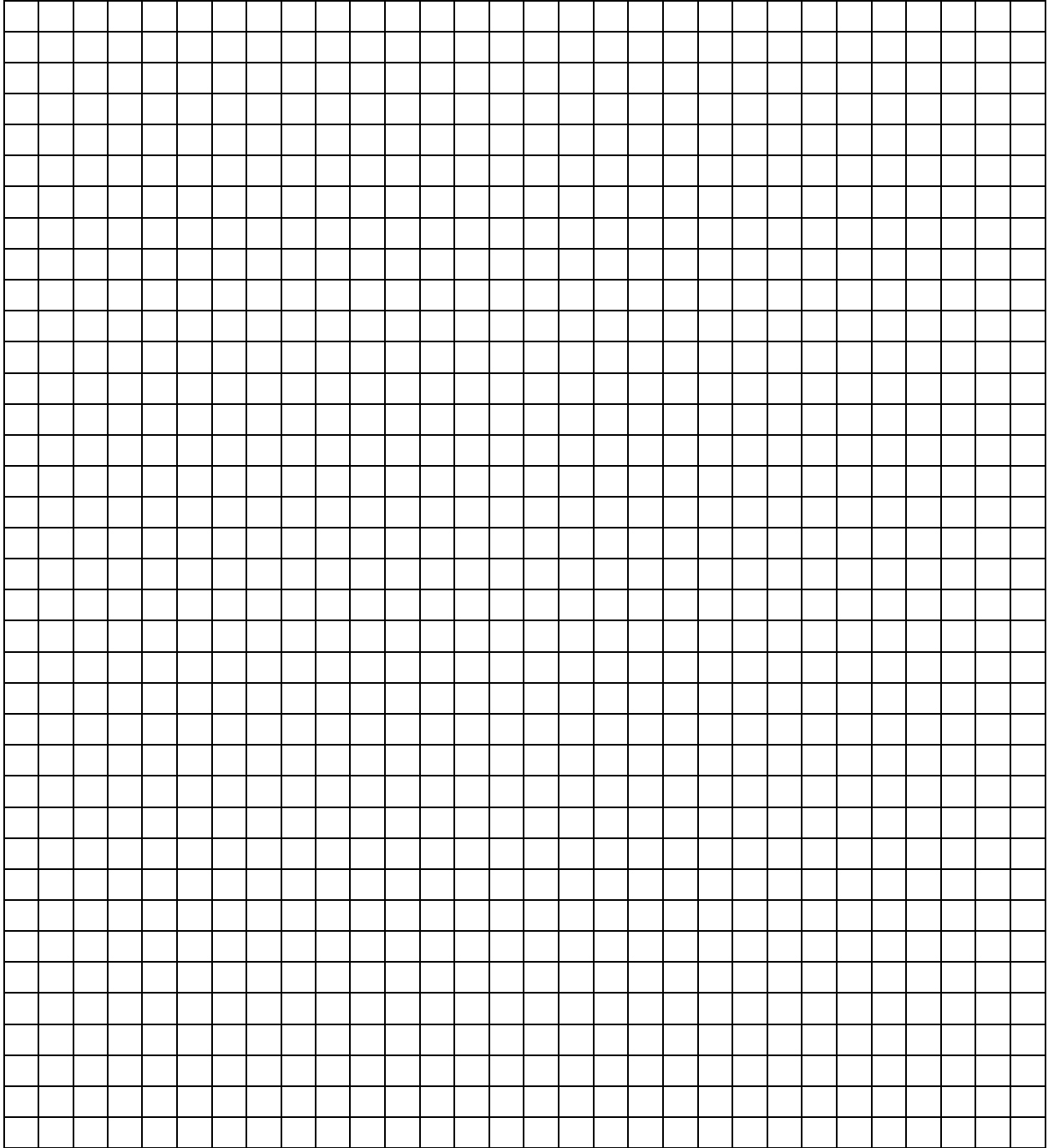

**NOTES:**

- 1) North arrow shall be correctly placed.
- 2) Draw a completely dimensioned plot plan.
- 3) Note adjoining streets and/or alleys.
- 4) Note curb cuts.

Owner
Street Address
Phone No.